

The Perennial



2015-2016
Issue 7: March

Website:
ArlingtonGarden.org

The roller coaster weather has continued into this month. The good news is that we are receiving some substantial rainfall. And of course the best news is that spring is around the corner on March 20. There is an important article below regarding evening meetings for next year.

Upcoming Programs:

Joint Day and Evening Program – March 31- 7:00pm
Senior Center, Main Room, 2nd Floor

Design Tips for Knockout, Easy-care Gardens presented by Kerry Ann Mendez. Kerry has been featured on HGTV and in numerous horticulture magazines and is the recipient of the 2014 Gold Medal from the Massachusetts Horticultural Society.

Gorgeous, low-maintenance gardens are no accident. Learn proven design tricks for sensational gardens. Topics include selecting great plants, incorporating focal points, vertical interest, sustainable practices, natural repellents, the how's and when's of using fertilizer and more.

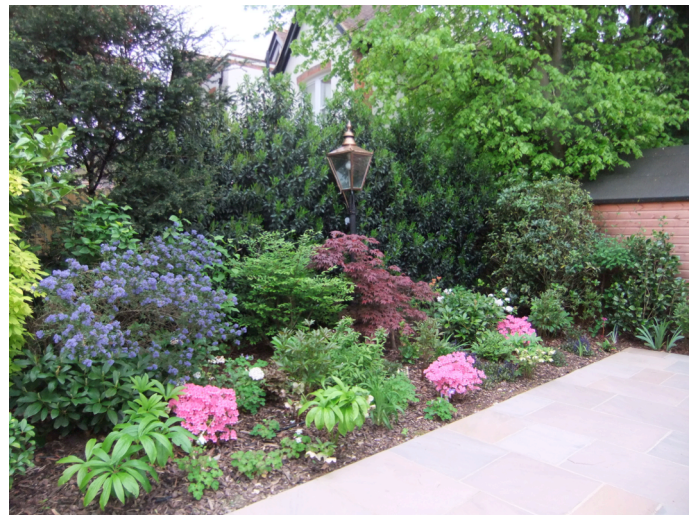

Please note: there will be no daytime meeting in March



Day Meeting – April 13 10:30

St. John's Episcopal Church

Say It With Flowers – Thelma Shoneman,

nationally accredited flower show judge and exhibitor for over 21 years at the MFA's Art in Bloom. Thelma will create six expressive designs, explaining techniques and elements as she works her magic.

Evening Meeting – April 28 7:00

Senior Center – Art Room 2nd Floor

Gardening with Native Plants and Why It

Matters – Claudia Thompson, President of Grow Native Massachusetts. Claudia will give us an overview of the essential role of native plants and explore the relationships that link plants to insects, birds, wildlife and humans.



No Evening Meetings for the 2016-2017 Season Nancie Richardson, President

After much thoughtful discussion, the Board has voted to suspend evening meetings for the 2016-17 season. This was not an easy decision for a program we have been running for the past nine years and realize it will be disappointing to members. However, the continual low attendance coupled with the costs for speakers and hall rental forced this decision.

Over next season we will investigate the possibility of a different format and/or offering for those who can only attend meetings at night.

Garden Therapy – Ginger Tower

Garden Therapy met on Monday, March 7th. Carol Nahigian provided the project and spring was definitely on her mind. The residents all received either a yellow or green basket that they filled with spring flowers, pussy willow, and, for an extra treat, chocolate Easter eggs! Keeping with the spring theme, Robin Watkins brought delicious homemade zucchini bread and colorful fresh fruit served on lime green plates and napkins. We could almost smell spring! Of course, no meeting is complete without our song fest led by Carol Nahigian and accompanied by Lily Heckard on the piano.

There are only two more Garden Therapy meetings this year. If any members are curious about Garden Therapy, but would like to "try it out" first before joining, please feel free to stop by on Monday, April 4th, and Monday, May 2nd, 9:45 to 11 o'clock, at the Park Avenue Health Center, 146 Park Avenue. We hope to see you there!

Environmental Corner – Climate Change - Mary Stack

Editor's Note: Mary's article is especially timely as the Garden Club will be co-sponsoring EcoFest this Saturday, March 19. Please see poster below.

Scientists are concerned about how climate change will affect the spread of invasive plants. Although there are no definitive answers, researchers are asking questions and using their knowledge of the past behavior of invasive plants to predict how global warming will affect their future spread. They are not optimistic. Warmer winters may help invasive plants expand their ranges. Their adaptability could enable some invasive plants to survive changing rainfall patterns. More catastrophic weather events such as microbursts, hurricanes and tornadoes may cause destruction of native plants and their habitats giving non-native plants an opportunity to take over wide areas.

During his stay at Walden Pond, Henry David Thoreau recorded the plant species he found in the area and their flowering times. Harvard scientists are now using this data to study the effects of climate change by focusing on flowering times. Early flowering plants have a marked advantage. They get more sun and produce seeds ahead of their competitors.

The average temperature in Concord has increased by 4.3 degrees Fahrenheit in the past 150 years. The Harvard study comparing Thoreau's records to current data showed that the flowering time for plants at Walden Pond has advanced by an average of one week in the spring. Although one week was the average, there was a wide variation among different families of plants. Some plant families flowered as much as 20 days earlier while others flowered only a few days earlier than Thoreau's recorded times. The study found that plants that were not able to adjust their flowering time have decreased in abundance.

According to this study "Some 27 percent of all species Thoreau recorded in the mid-19th century are now locally extinct, and another 36 percent are so sparse that extinction may be imminent. Plant families that have been especially hard-hit by global warming have included lilies, orchids, buttercups, violets, roses, dogwoods, and mints. Many of the gainers have been weedier mustards and knotweeds, along with various non-native species."

Plant Sale – Saturday, May 21

It's that time of year when we need to start thinking about this major fundraiser for the garden club. This year we need new co-chairs. Gerry Ricci kept great notes and has great reference records to help make the job a breeze. If you are considering this position, please contact Nancie Richardson. And don't forget to start saving clean, quality items for the flea market which can be brought to 32 Mount Vernon Street anytime after April 15. Please call Nancy Pike at [781-646-4121](tel:781-646-4121) before you come over to make sure someone is home to open the brand new cellar door.



EcoFest 2016



READY FOR CLIMATE CHANGE?

SATURDAY, MARCH 19, 2016 10:00 AM – 2:00 PM
ARLINGTON TOWN HALL, 730 MASSACHUSETTS AVE

***** FREE ADMISSION *****

These events in Lyons Hearing Room, 2nd Floor:

10:30 am: Liz Buchanan - Children's Musician

11:30 am: Keynote Speaker: Cammy Peterson
Clean Energy Manager, Metropolitan Area Planning Council
Regional Climate Change Preparedness

12:30 pm: Leonard Solomon - One-Man Band

Trashformations - A Recycled Art Exhibit

- **Raffle**
- **Free Compost** (Bring container)
- **Discounted Rain Barrels & Composters**
- **Food Link Cafe** (own cup = free coffee)

Information: Patsy Kraemer 781-858-8629 patsy@patsykraemer.com
www.arlingtonma.gov/ecofest

Welcome to our new board:

Many thanks for the hard work of the nominating committee. The board members for the 2016-2017 season are:

President	Patsy Kraemer will serve for 1 year
VP Operations	Emily Snyder will serve for 1 year
VP Day Programs	Janet Pagliuca continues
VP Eve. Programs	No successor for 2016-17
Treasurer	Mary Rogers
Recording Sec.	Joan Robbio continues
Membership	Jackie Keshian
Environment	Mary Stack continues
Garden Therapy	Ginger Tower/Irene MacKinnon continue
Publicity	Flo Dunlap continues
Hospitality	Barbara Neenan
Civic Development	Jane Foley continues

Learning opportunities:

Spring Wildflowers: Ephemeral Beauty with a Purpose

**Sponsored by Grow Native Massachusetts – Cambridge Public Library –
449 Broadway, Cambridge**

Carol Gracie, Author of [Spring Wildflowers of the Northeast](#)

Our native spring wildflowers evolved in the once contiguous forests that stretched the length of the East Coast and west to the prairies. Their flowering coincides with increased sunlight and warmth before the forest canopy leafs out, and their associations with the early-flying insects of spring are remarkable. Come learn about the life cycles of selected species in detail— and why many populations are in a marked decline due to human activity. By understanding their evolutionary relationships to forest habitat, we can better protect these ephemeral beauties on all lands, and integrate them into our woodland gardens.

Happy Spring



Blood Root
Sanguinaria canadensis



Large White Trillium
Trillium grandiflorum

